

# BRENNAN HALL, JOSEPH M. MCSHANE, S.J. EXECUTIVE CENTER

## Pearn Auditorium (228)

Capacity: 142

Recommended Events:

- Lectures
- General assemblies

Set Up: Permanent theater seating

Food Service: Not allowed inside auditorium, only in lobby area. Submit food service form at least one week in advance

Disabled Accessible: Yes

Specifications:

- Portable lectern with touch screen control system on stage
- *do not move lectern before disconnecting wires from the floor box*
- Rear projection video projector with 9' x 7' glass screen
- Fixed and wireless microphones
- Dedicated computer with wireless keyboard and laser pointer
- Voice reinforcement system with audience interaction capability
- CD/cassette background music source
- Dedicated VCR, DVD with Dolby 5.1 surround sound
- Network and laptop connectivity at each seat
- Telephone jack on stage floor and in projection room (ext. 5855). Contact Network Services for a phone instrument.
- Stage and audience microphone input connection for panel discussion
- Slide projector
- Satellite downlink (teleconference) capability
- *confirm with OIT for equipment set up at least one week in advance at <http://www.scranton.edu/oitrequest>*
- Separate stair entrance with lobby and reception area
- Air conditioned
- Available for evening use

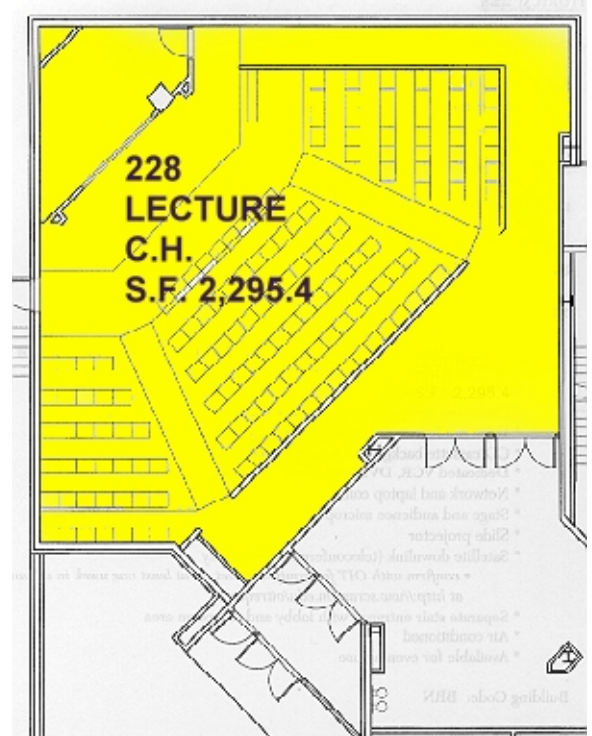

Building Code: BRN

Room Code: 228