

REDINGTON HALL

Collegiate Hall

Capacity: 144 lecture
72 dining with existing tables
144 dining with rental tables

Recommended Events:

- Meetings
- Seminars
- Lectures
- Dining events
- Presentations

Set Up: Tables along the perimeter are stationary – submit a work order to Physical Plant for other set up needs

Food Service: Yes

Accessible: Yes

Specifications:

- This area is a student lounge. Requests during the school year need to be directed to Residence Life for approval.
- Twelve 7 ft. study tables with lamps around the perimeter of the room. Tables cannot be moved however; by submitting a work order the lamps can be removed.
- Two 8 ft. tables
- Dining for 72 people utilizing study tables, 144 with rented round tables arranged in the center
- 118 chairs (additional chairs need to be rented)
 - 48 wooden chairs at study tables/70 Kruger
- Coat rack
- Platform stage dimensions – 19 ft. x 8 ft.
- Sound system
- Not recommended for dances
- Limited hours for events during the school year
- Teleconferencing capable – a call needs to be placed to OIT confirming connection at least one week in advance.

Building Code: RED

Room Code: COL

300
COLLEGIATE HALL
C.H.
S.F. 3,133.7

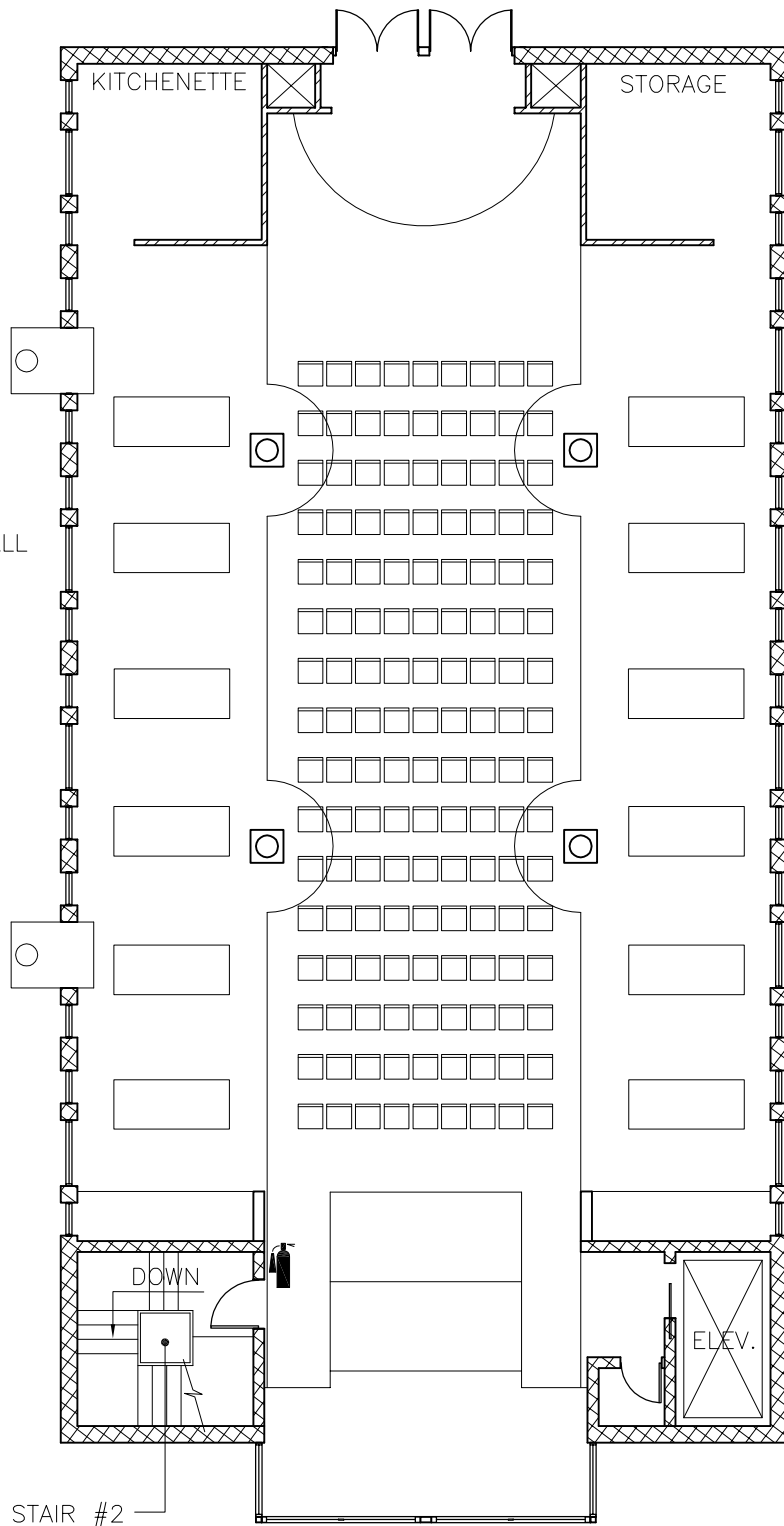

300
COLLEGIATE HALL
C.H.
S.F. 3,133.7

